



LabP 01 Instruction Manual rel. 1.2 (07/2017)

- Symbols -

Capricorn RC

L/R

Symmetrical
Mounting

2x

Assemble as many
times as specified

1 2
3 4

Assemble in the
specified order

Note:
TEXT....

Be Careful

WARNING

This radio control model is not toy.

First time builders should seek the advice of experienced modellers before beginning assembly and/or if they do not fully understand any part of the construction. We highly advise to read the instruction manual before assembly, and to always keep it at hand for reference. Take care before operating this model; you are responsible for its assembly and safe operation. The extreme performance of this model could be underestimated by inexperienced drivers and could damage objects and/or people. Assemble this kit only in places out of children's reach!

CAPRICORN RC is not responsible for any damage or harm caused by improper use or assembly.

CAPRICORN RC and its distribution network are not responsible for any damage caused by shipping or handling.

Eventual parts missing from the kit or flawed must be reported within two weeks of purchase to your local hobby shop or distributor.

For best performance, we highly advise to only use original authentic CAPRICORN RC parts.

For customer support and service please contact your local hobby shop or agent from whom you purchased this item.

Contents of box may slightly differ from the pictures shown. Construction tools, body, tires, radio system and servo, ESC, motor and battery pack are NOT INCLUDED unless otherwise stated.

Made in Italy



Tools needed for assembly (NOT INCLUDED)

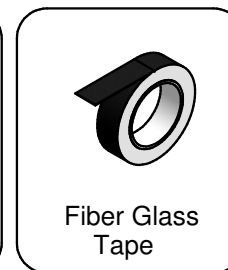
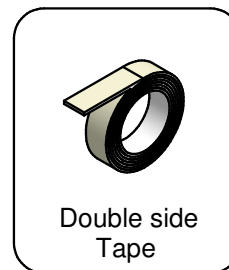
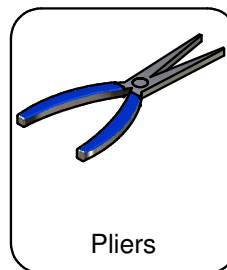
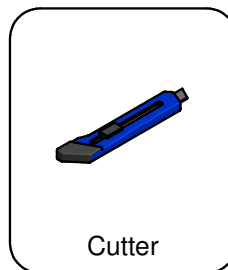
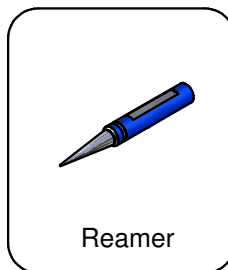
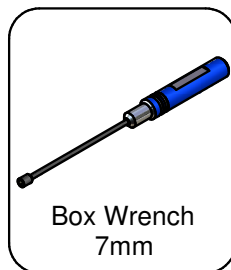

Parts for model completion and Start (NOT INCLUDED)

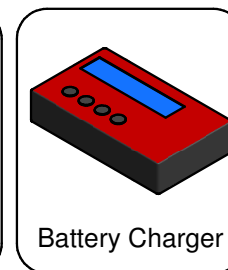
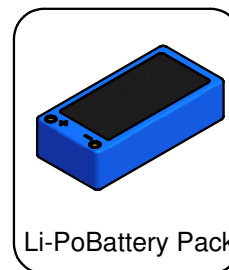
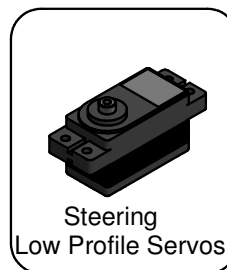
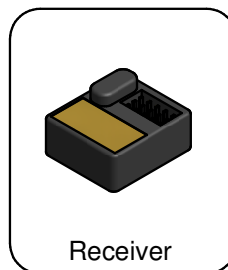
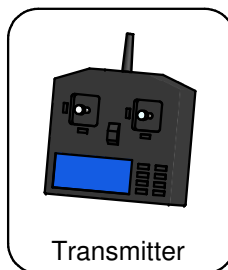
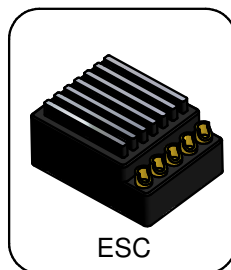
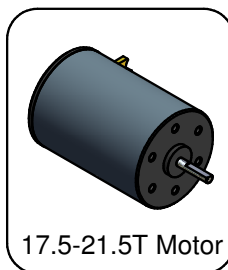

Also required: Tires - F1 Polycarbonat body - Front & Rear Wing

Step 1.0

- Front Assembly -
BAG 1

Capricorn RC

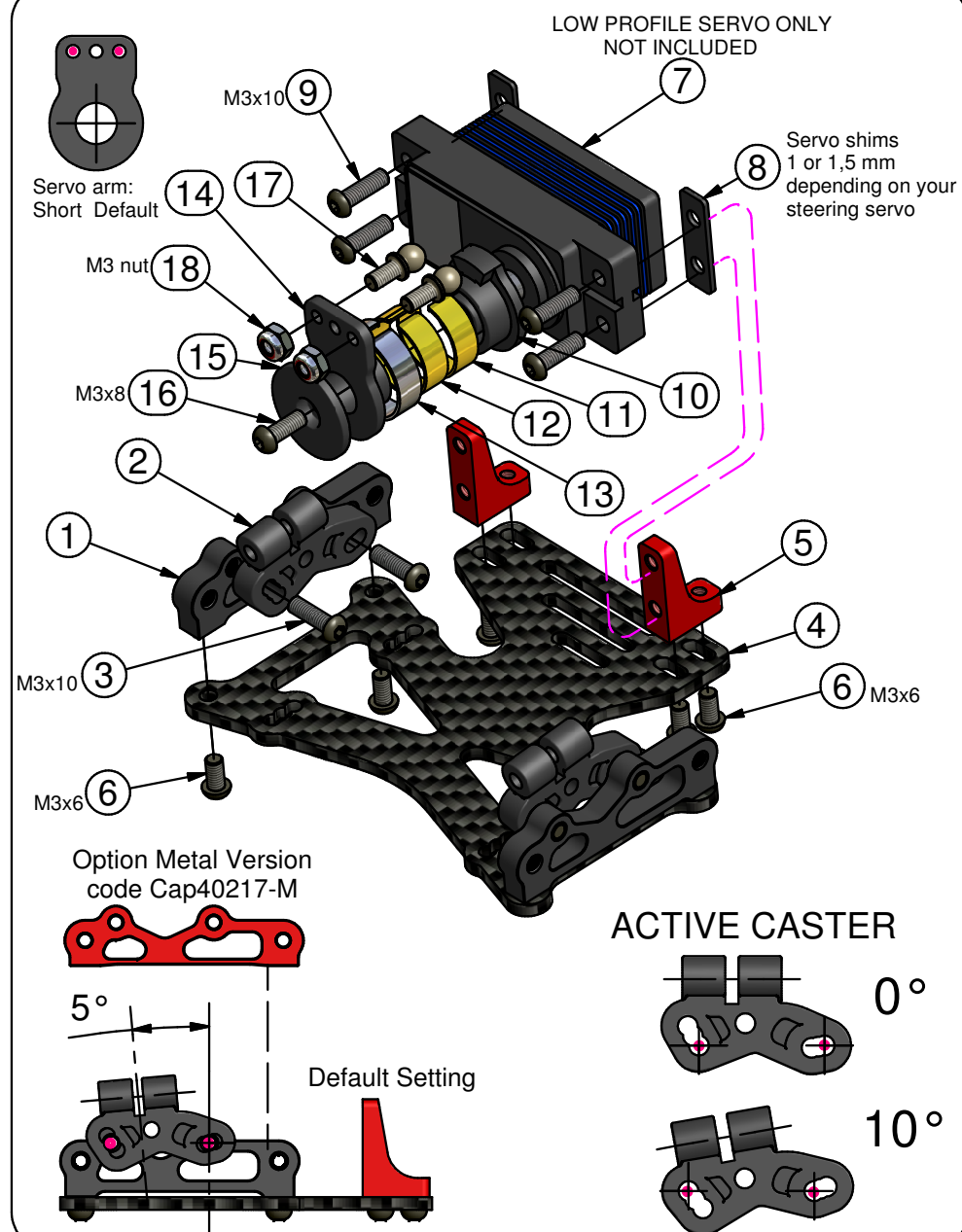
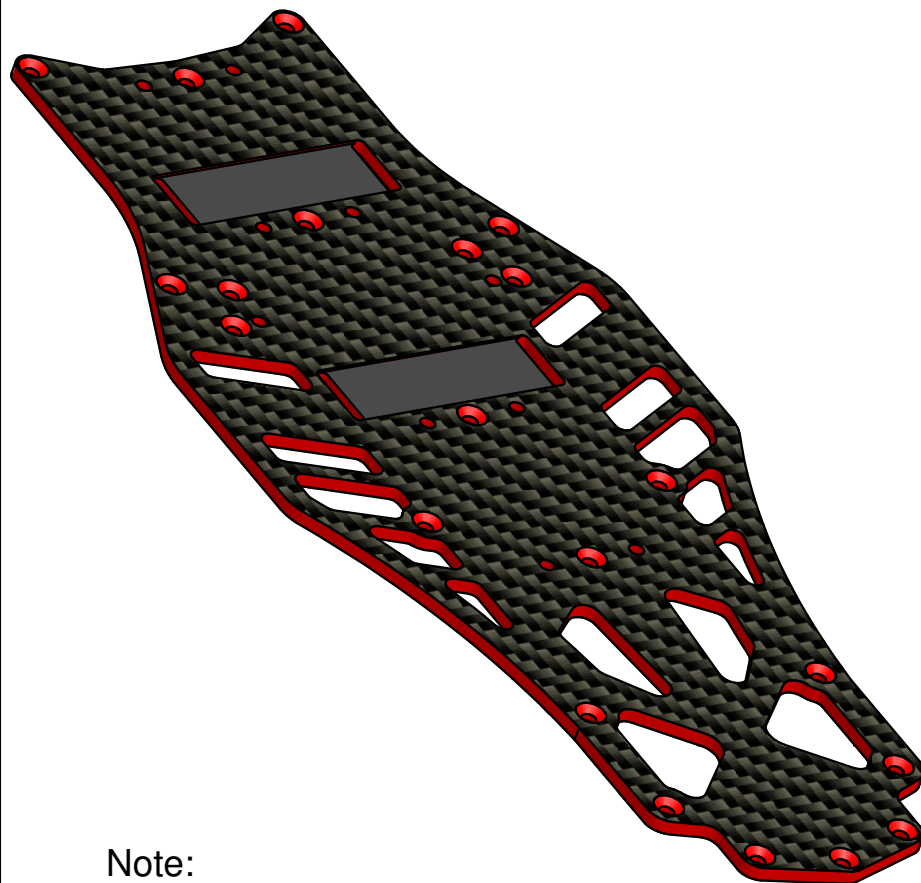

Step 1.1

- Front Assembly - BAG 1

Capricorn RC

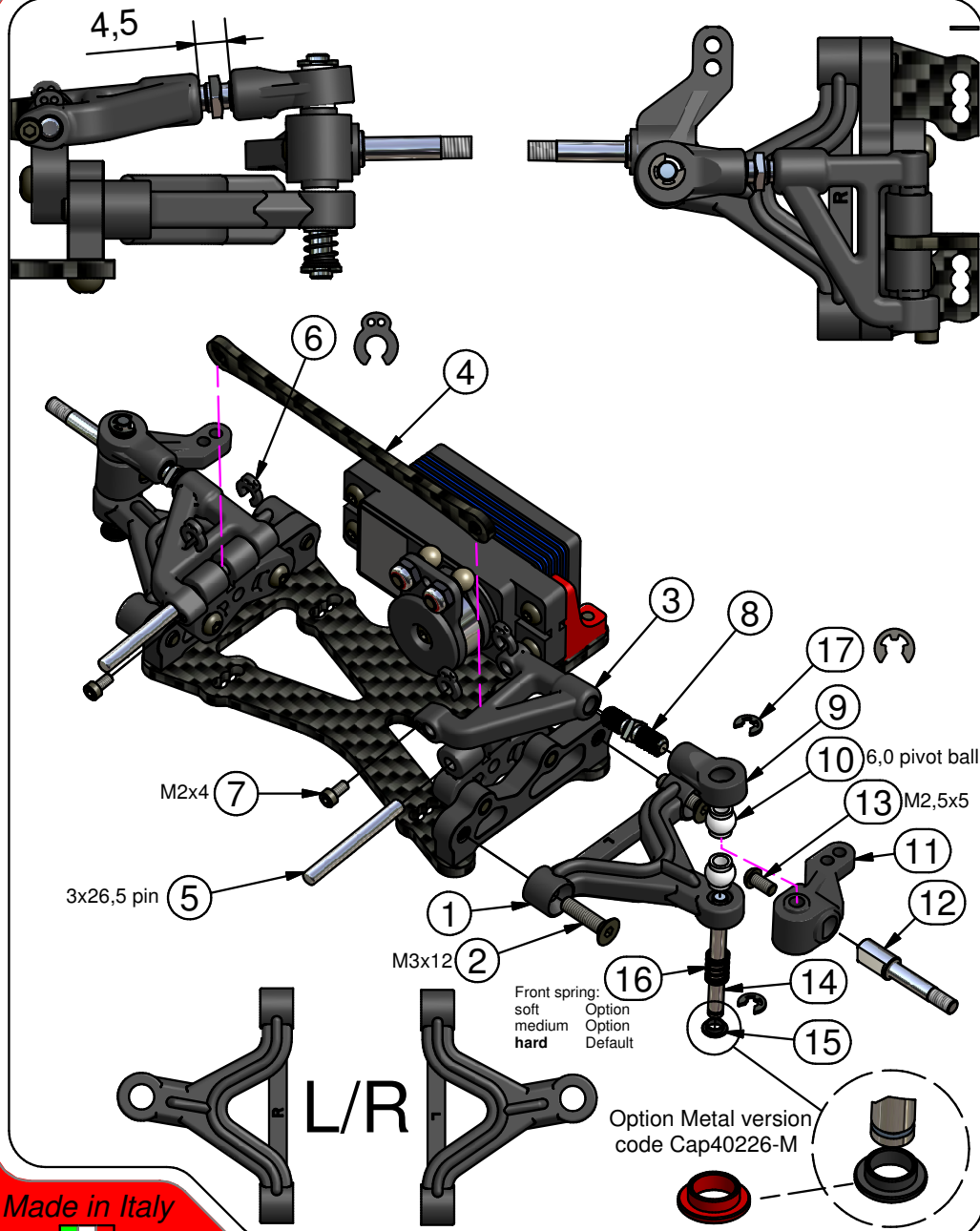

WHEELBASE Default Setting

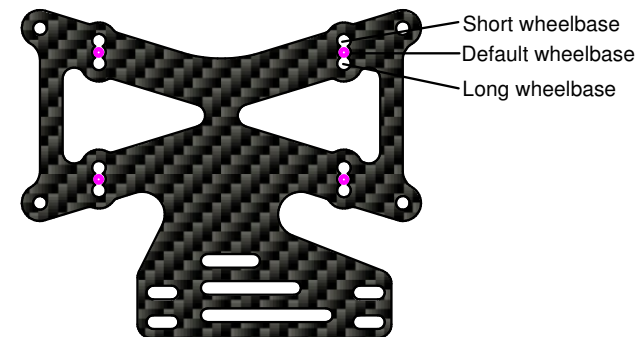

L/R

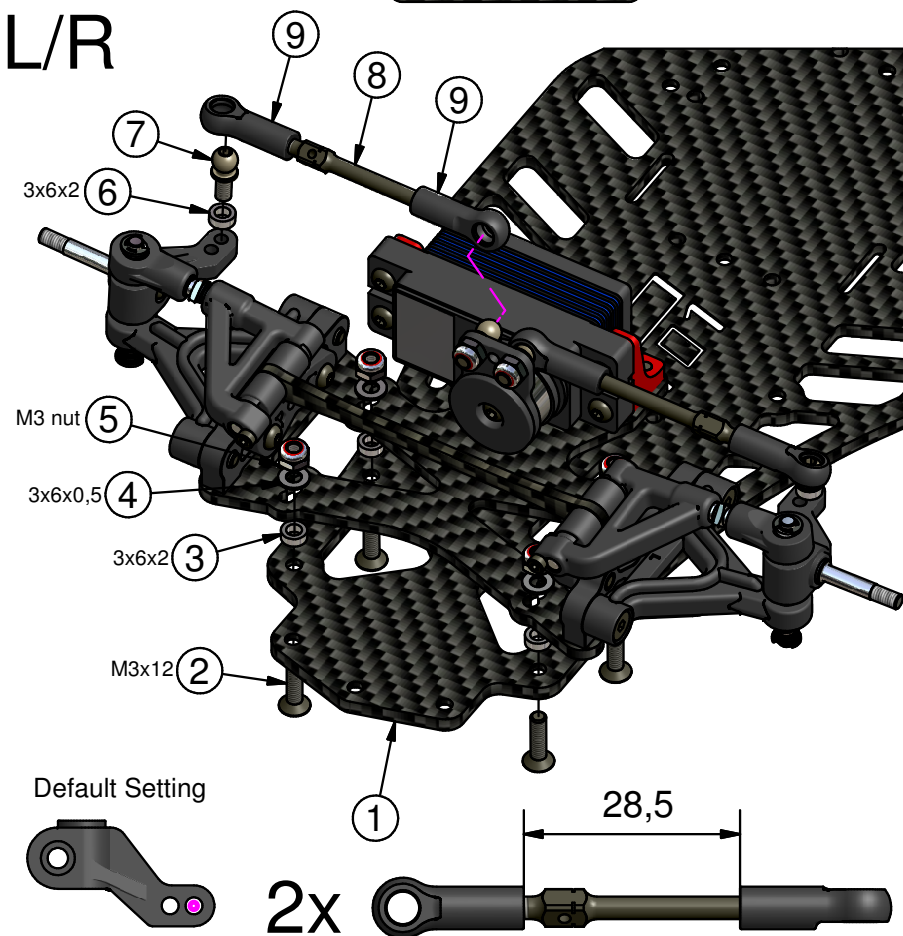

Made in Italy



Step 2.0

- Center Assembly -
BAG 2

Capricorn RC

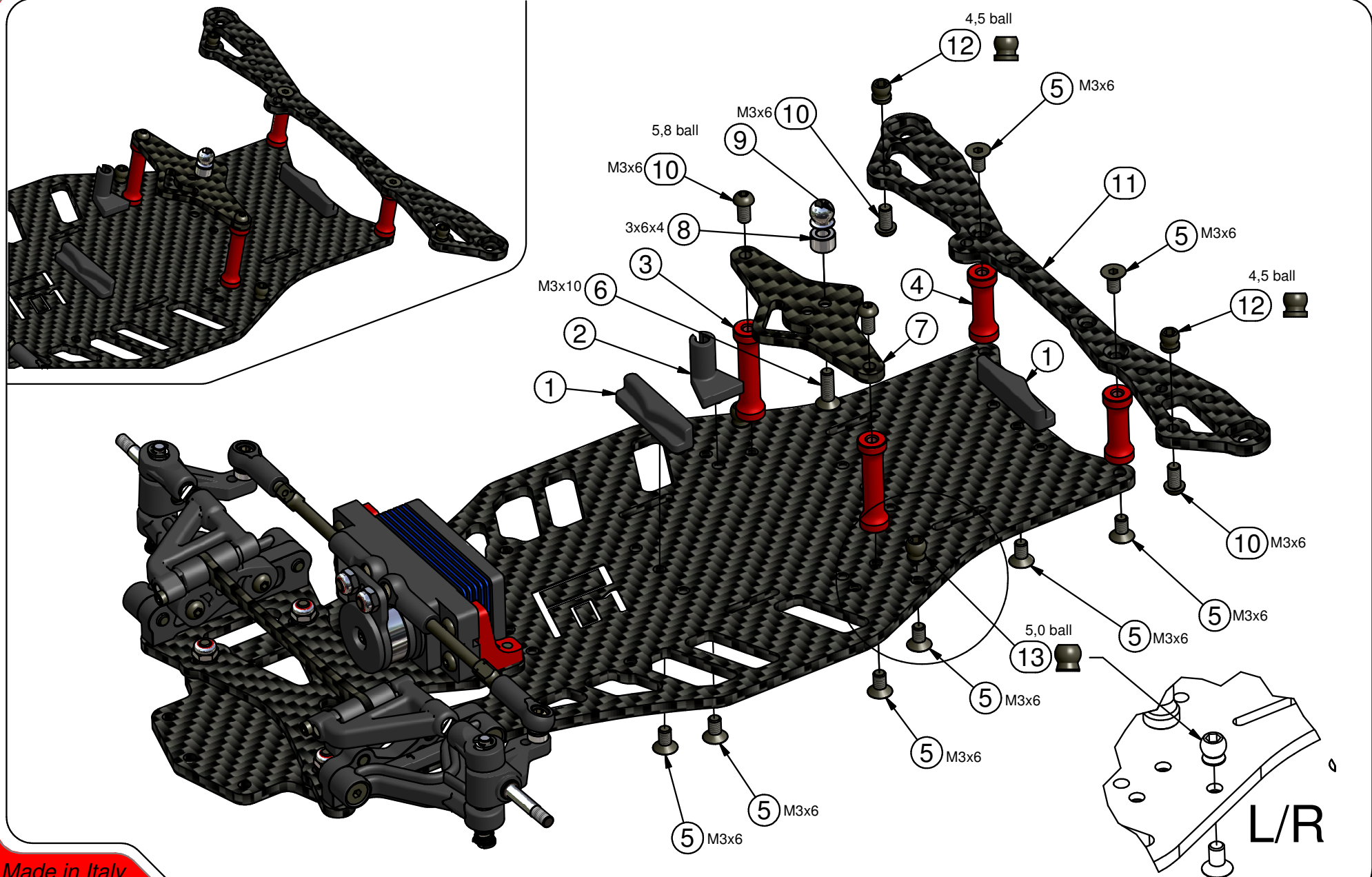

Made in Italy



Step 2.1

- Bumper & body mount -
BAG 2

Capricorn RC

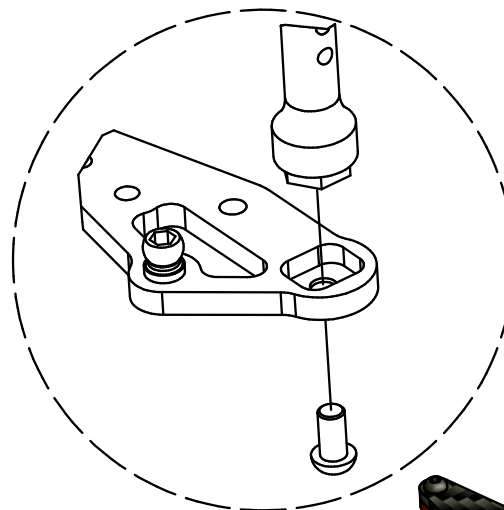
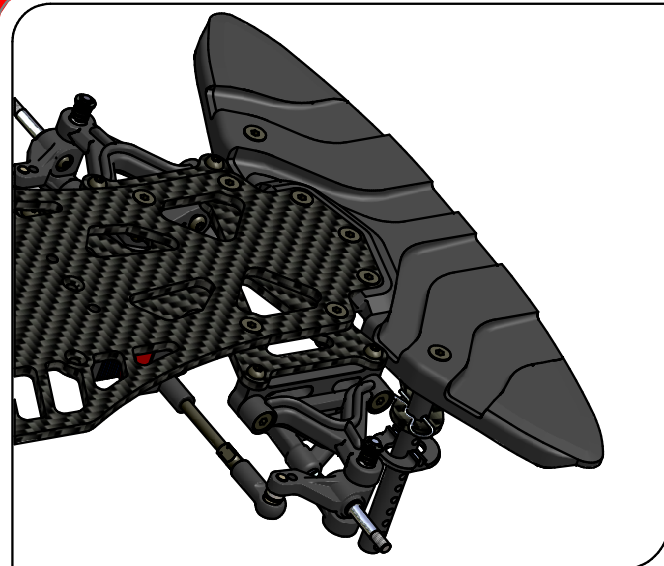

L/R

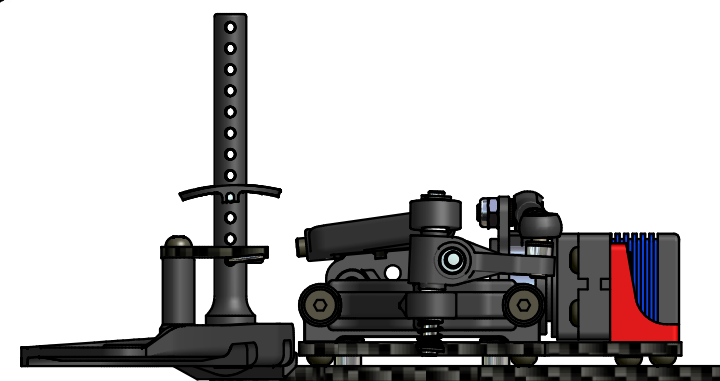
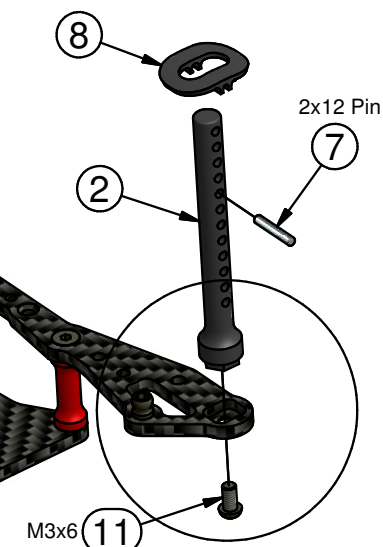
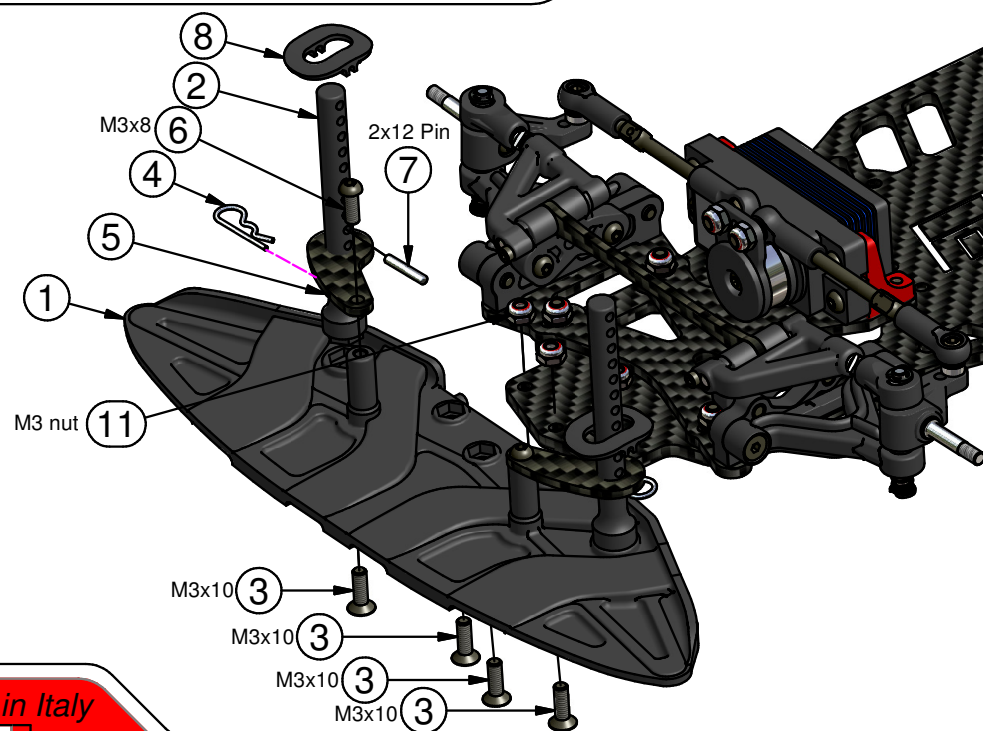

Made in Italy

Step 3.0

- Rear Assembly - BAG 3

Capricorn RC

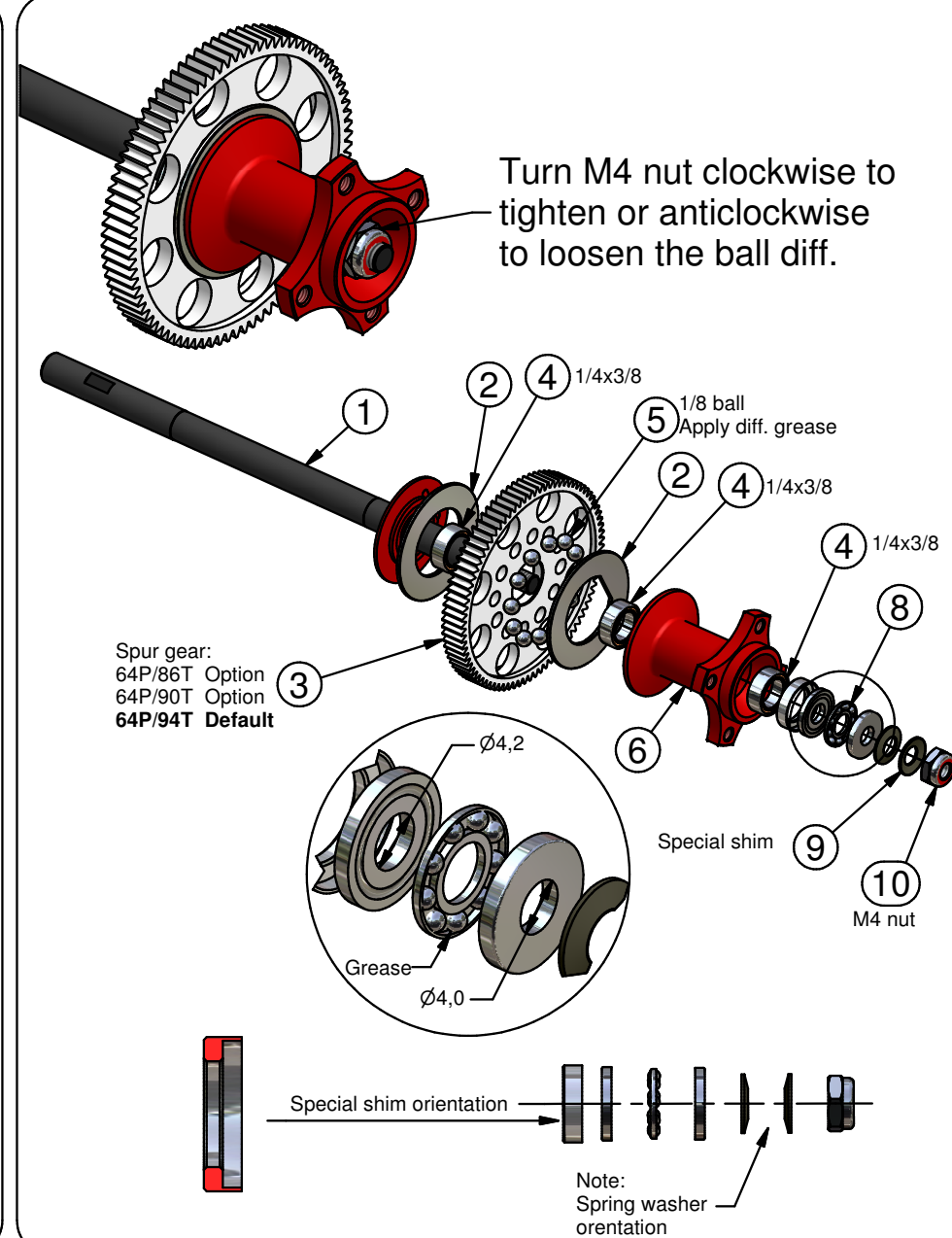
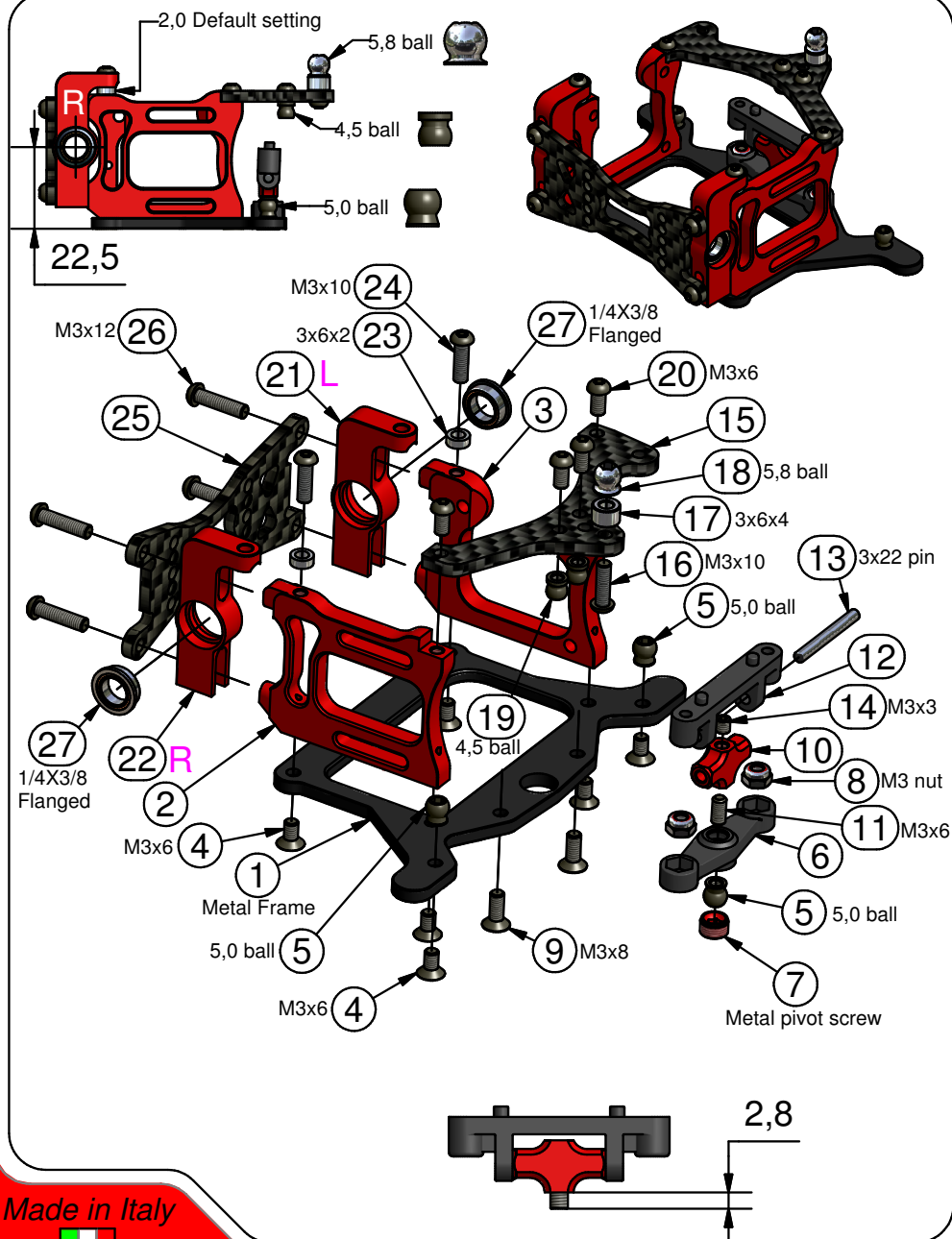

Made in Italy



Step 3.1

- Rear Assembly - BAG 3

Capricorn RC

Note:

Rear axle must have a small
amount of sideplay (0,1:0,15)

M2,5x8

shim
1/4x5/16x1/128
(6,4x8x0,25)

Note:

Use additional shims to
widen the rear track-width

M3x14

3x1,78 ORing

L/R

Side spring:

soft
medium
hard

Option
Default
Option

click

M2,5x6

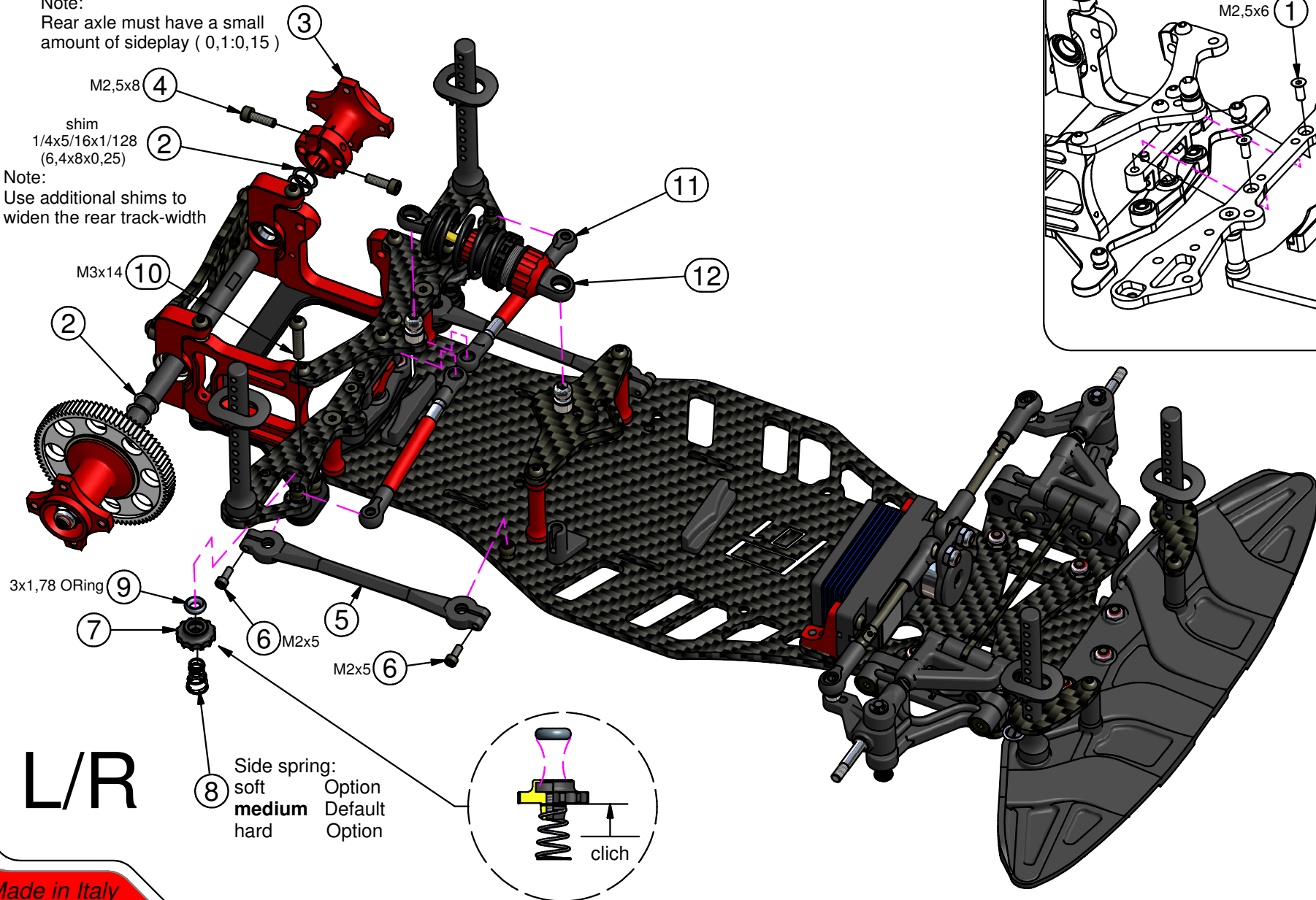
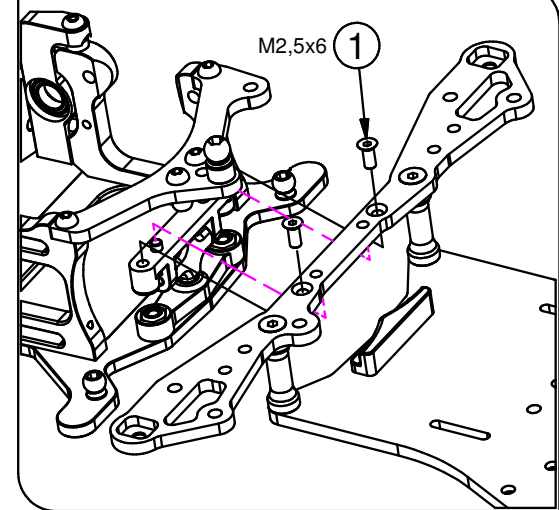

Made in Italy



Step 4.0

- Shocks -
BAG 4

Capricorn RC

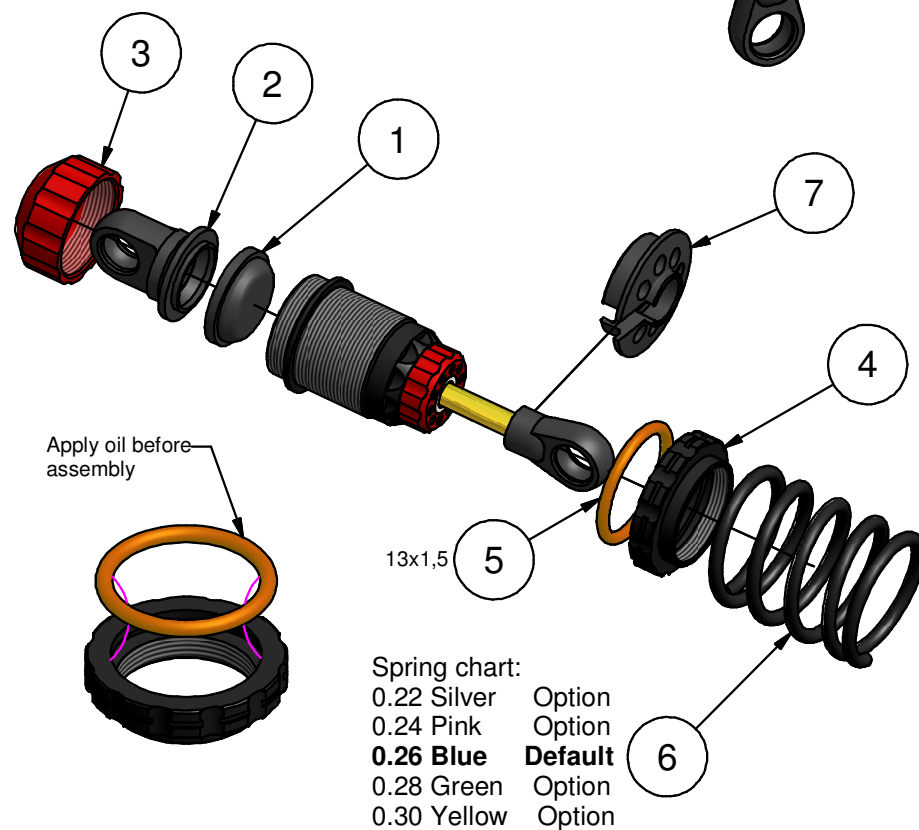
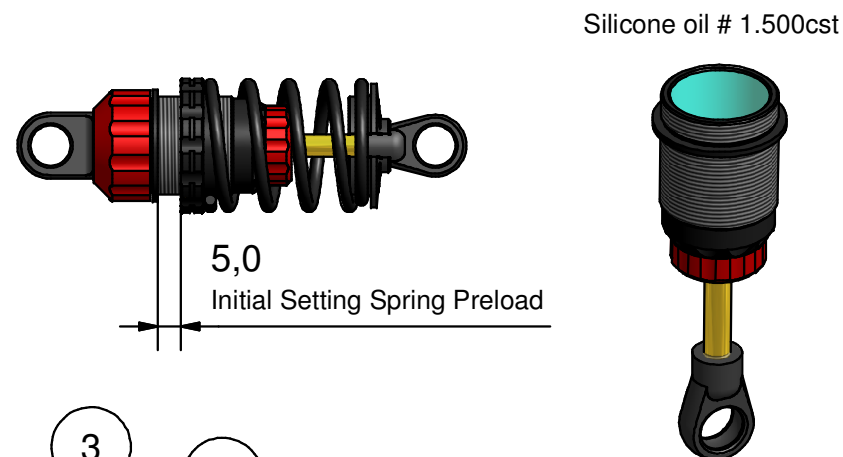
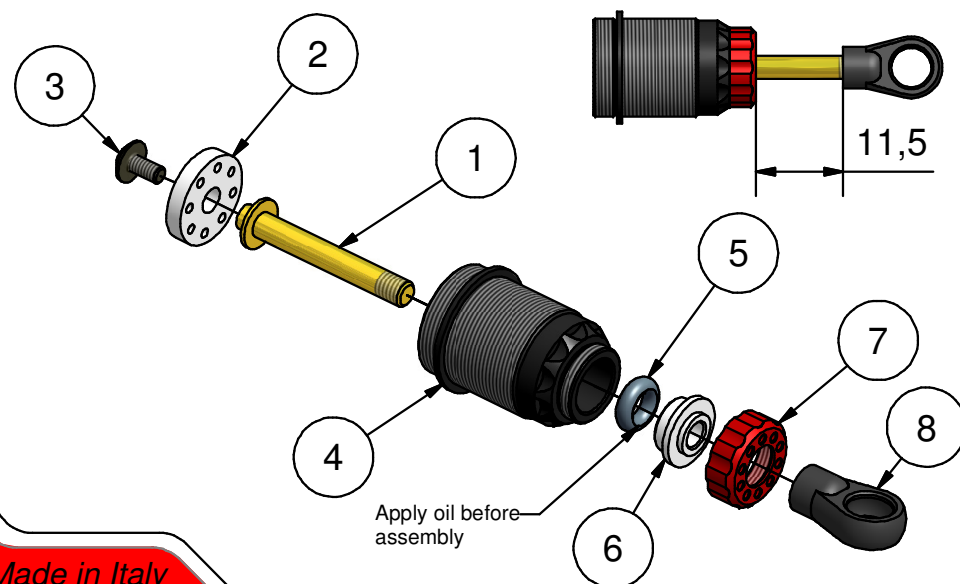
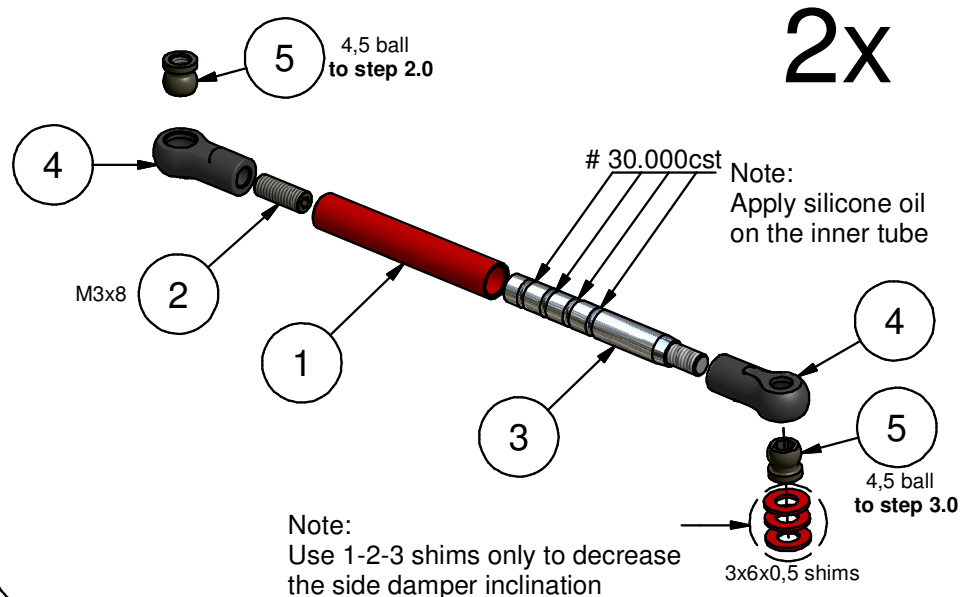

Made in Italy



Step 5.0

- Electronics Assembly - BAG 5

Capricorn RC

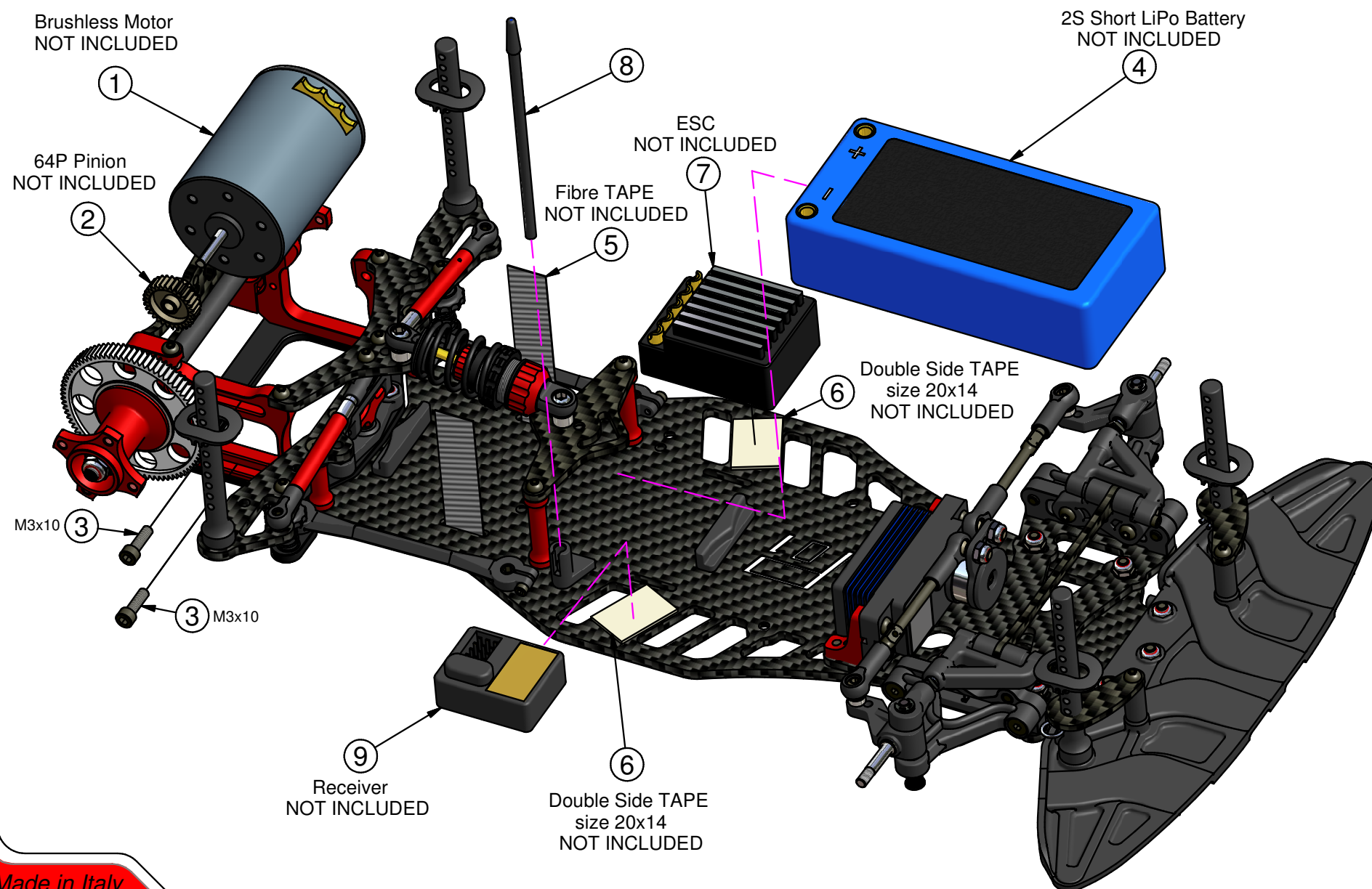

Made in Italy



Step 5.1

- Final Assembly -
BAG 5

Capricorn RC

L/R

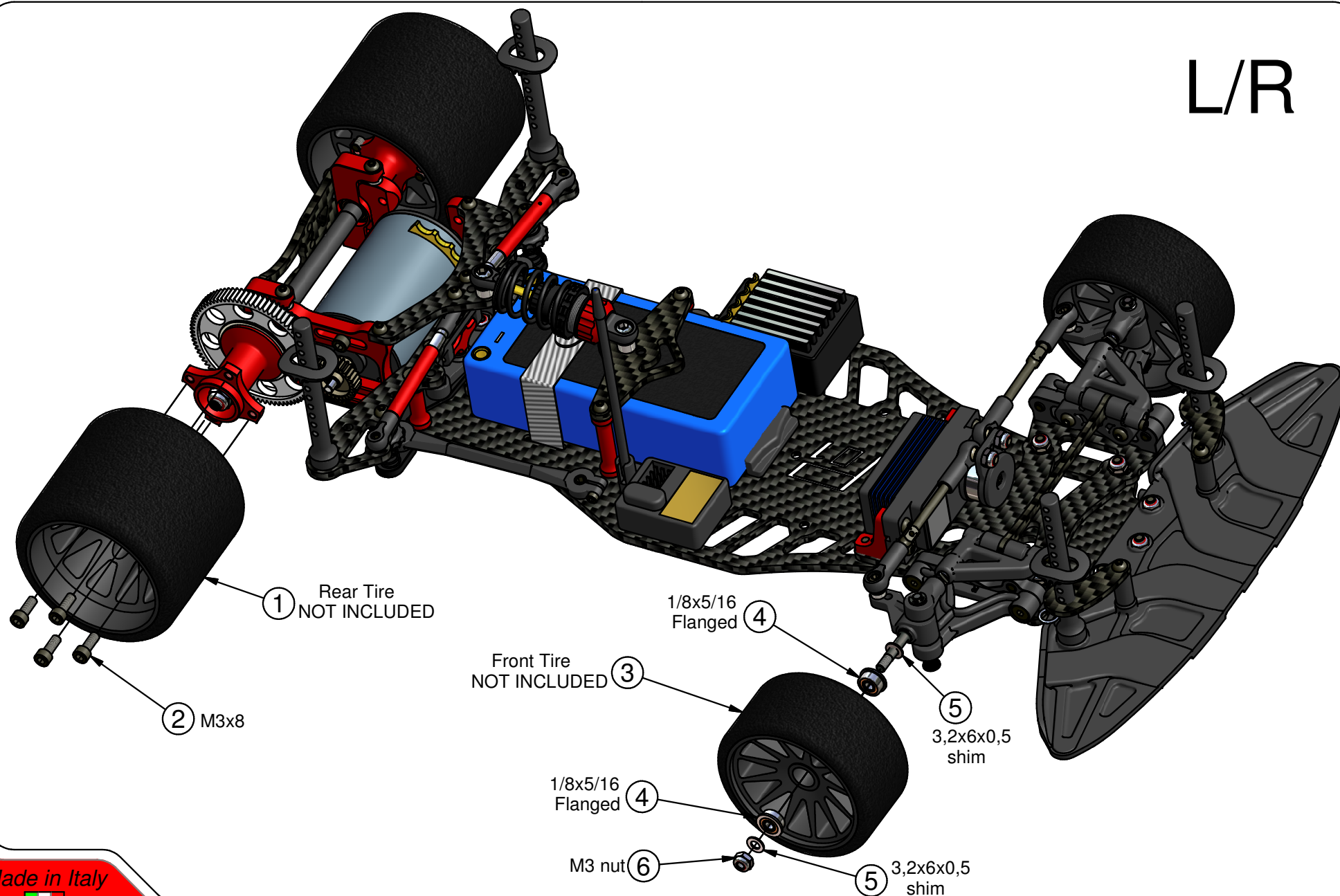

Made in Italy



Step 5.2

- Final Assembly View -

Capricorn RC

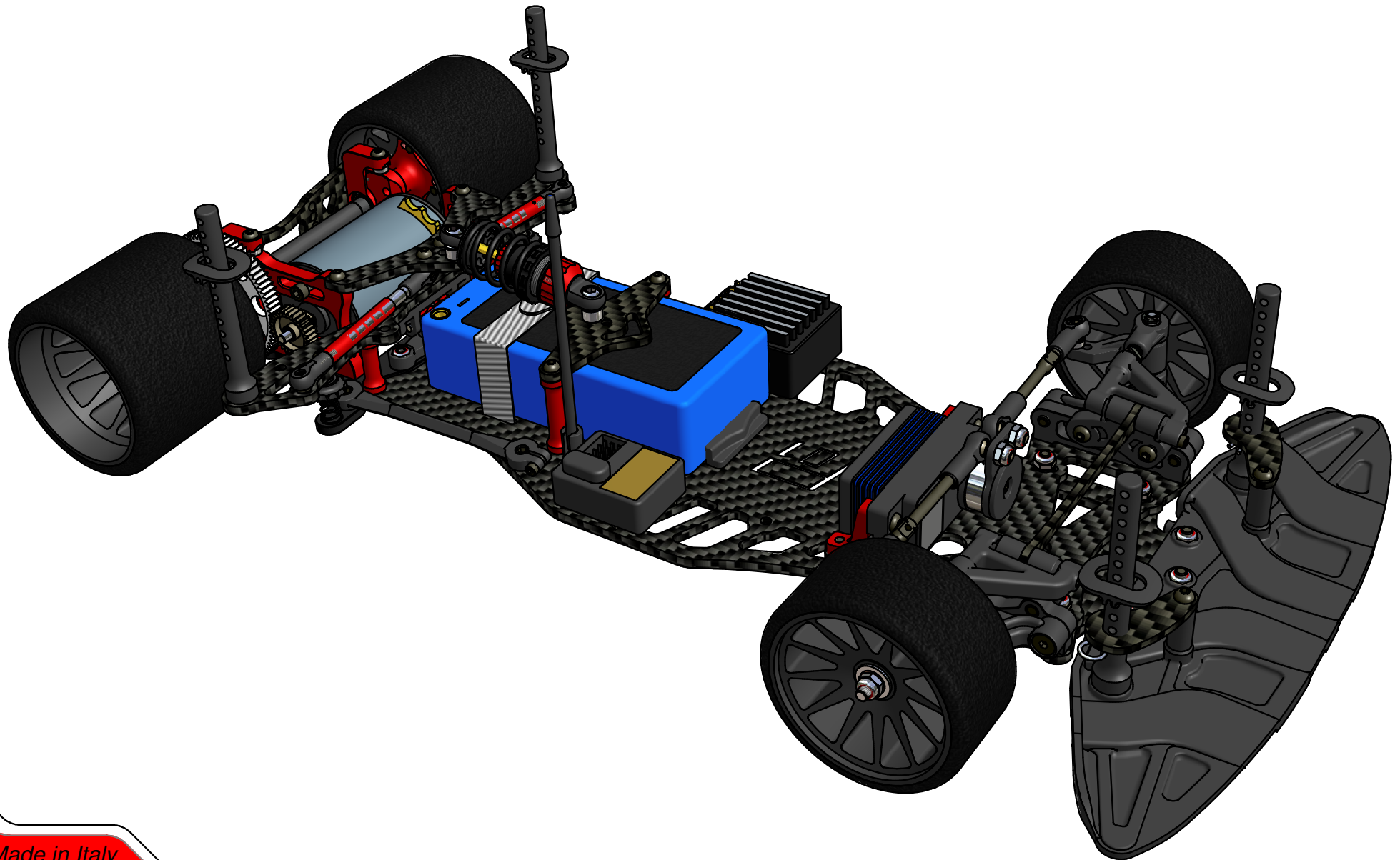

Made in Italy

P01 DEFAULT SET-UP SHEET

Capricorn RC

| | | | |
|------------------|--|---------------------|------|
| RACE | | DATE | |
| TRACK | | QUALIFYING POSITION | |
| NAME | | BEST LAP | /sec |
| CITY/ COUNTRY | | RACE POSITION | |
| CONTACT | | RACE LENGTH | /min |

| | | |
|---------------|------------------------------------|---|
| TRACK SURFACE | <input type="checkbox"/> CARPET | <input checked="" type="checkbox"/> ASPHALT |
| TRACK LAYOUT | <input type="checkbox"/> TECHNICAL | <input checked="" type="checkbox"/> MIXED |
| TRACTION | <input type="checkbox"/> LOW | <input checked="" type="checkbox"/> MEDIUM |
| | | <input type="checkbox"/> FAST |
| | | <input type="checkbox"/> HIGH |

| CENTER SHOCK ABSORBER | | | | SIDE SHOCK |
|-----------------------|--------|----------------|--------------|-----------------|
| BLUE SPRING | 8 HOLE | 1.500 OIL /CST | 30 REBOUND % | 30.000 OIL /CST |

| FRONT | TIRES | REAR |
|---|-------------|------|
| | B BRAND | |
| 40 | SHORE | 35 |
| 55 | DIAMETER | 56 |
| 193 | TRACK WIDTH | 195 |
| <div style="display: flex; justify-content: space-around;"> <div style="border: 1px solid black; width: 40px; height: 40px;"></div> <div>ADDITIVE TREATED AREA</div> <div style="border: 1px solid black; width: 40px; height: 40px;"></div> </div> | | |

| DIFF. SETTING | | |
|--------------------------------|---------------------------------|---|
| <input type="checkbox"/> LOOSE | <input type="checkbox"/> MEDIUM | <input checked="" type="checkbox"/> TIGHT |
| GEARING | | |
| 27 /T PINION | 94 /T SPUR GEAR | 3,48 DRIVE RATIO |
| MOTOR | 13,5 T | |
| ESC | | |
| BATTERY | LiPo 7,4 2S 4500 SHORTY | |
| BODY | | |

- NOTES -

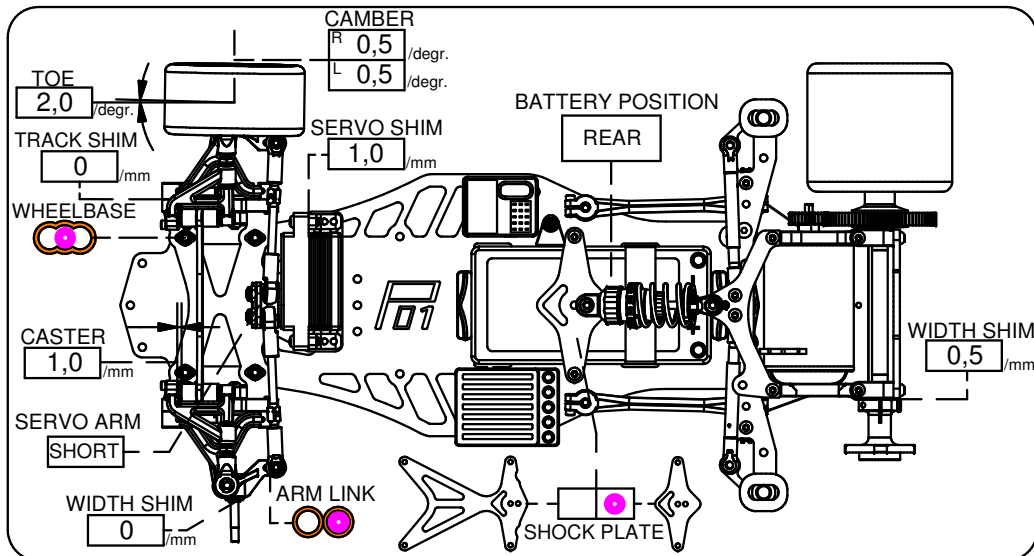
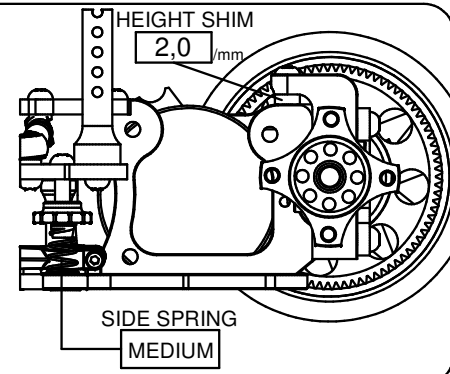
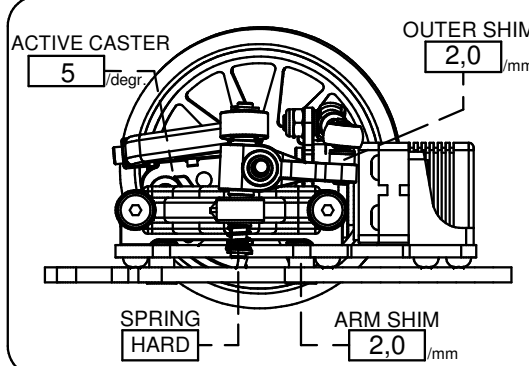
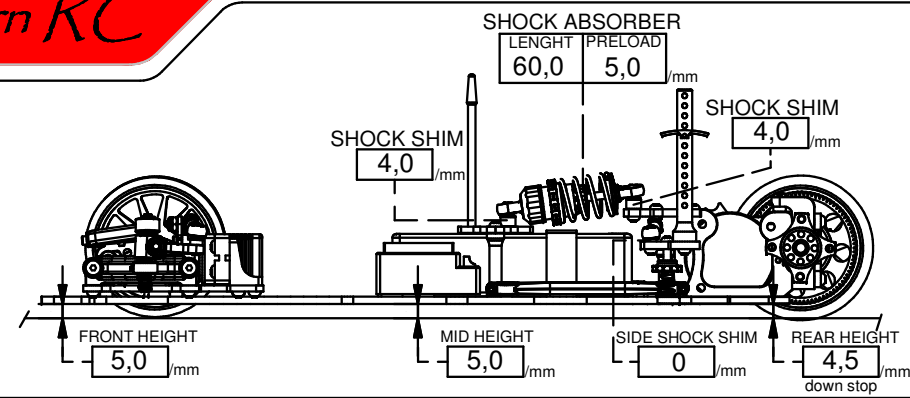

Made in Italy



P01 BLANK SET-UP SHEET

Capricorn RC

| | | | |
|------------------|--|---------------------|------|
| RACE | | DATE | |
| TRACK | | QUALIFYING POSITION | |
| NAME | | BEST LAP | /sec |
| CITY/ COUNTRY | | RACE POSITION | |
| CONTACT | | RACE LENGTH | /min |

| | | |
|---------------|------------------------------------|----------------------------------|
| TRACK SURFACE | <input type="checkbox"/> CARPET | <input type="checkbox"/> ASPHALT |
| TRACK LAYOUT | <input type="checkbox"/> TECHNICAL | <input type="checkbox"/> MIXED |
| TRACTION | <input type="checkbox"/> LOW | <input type="checkbox"/> MEDIUM |
| | <input type="checkbox"/> HIGH | |

| | | | | | |
|---------------------------------|-------------------------------|-----------------------------------|-------------------------------------|-----------------------------------|--|
| CENTER SHOCK ABSORBER | | | | SIDE SHOCK | |
| <input type="checkbox"/> SPRING | <input type="checkbox"/> HOLE | <input type="checkbox"/> OIL /CST | <input type="checkbox"/> REBOUND /% | <input type="checkbox"/> OIL /CST | |

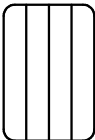
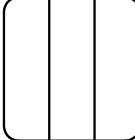
| | | |
|---|-------------|----------------------|
| FRONT | TIRES | REAR |
| <input type="text"/> | BRAND | <input type="text"/> |
| <input type="text"/> | SHORE | <input type="text"/> |
| <input type="text"/> | DIAMETER | <input type="text"/> |
| <input type="text"/> | TRACK WIDTH | <input type="text"/> |
| <div style="display: flex; justify-content: space-around;"> <div>  </div> <div> ADDITIVE TREATED AREA </div> <div>  </div> </div> | | |

| | | |
|--------------------------------|-----------------------------------|----------------------------------|
| DIFF. SETTING | | |
| <input type="checkbox"/> | <input type="checkbox"/> | <input type="checkbox"/> |
| LOOSE | MEDIUM | TIGHT |
| GEARING | | |
| <input type="text"/> PINION /T | <input type="text"/> SPUR GEAR /T | <input type="text"/> DRIVE RATIO |
| MOTOR | | |
| ESC | | |
| BATTERY | | |
| BODY | | |

- NOTES -

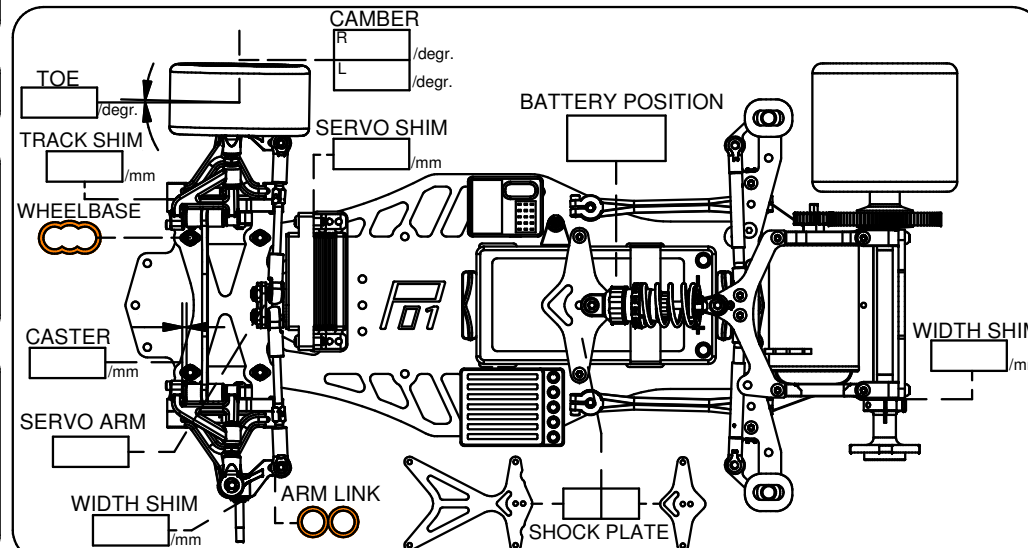
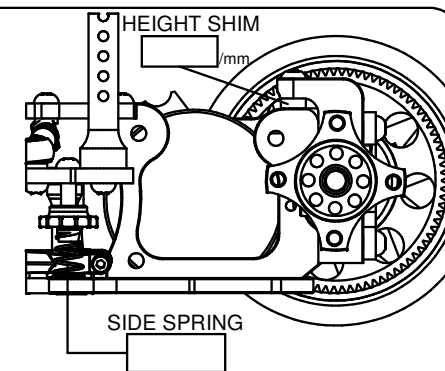
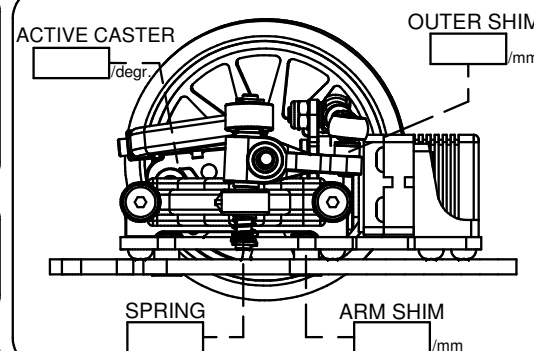
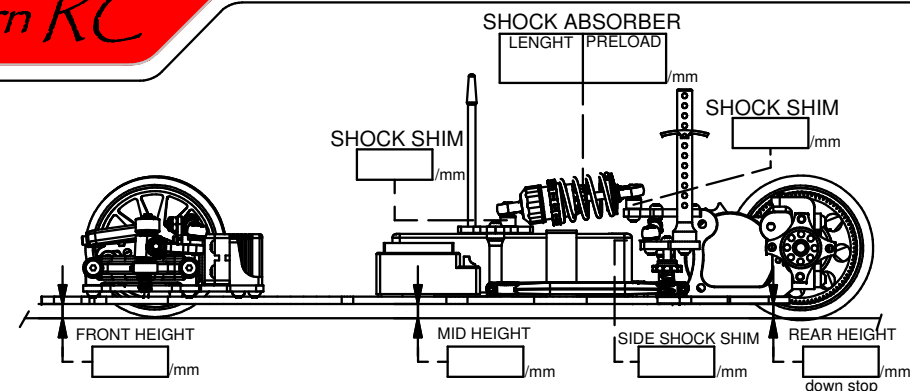

Made in Italy



- Shocks & axle exploded -

Capricorn RC

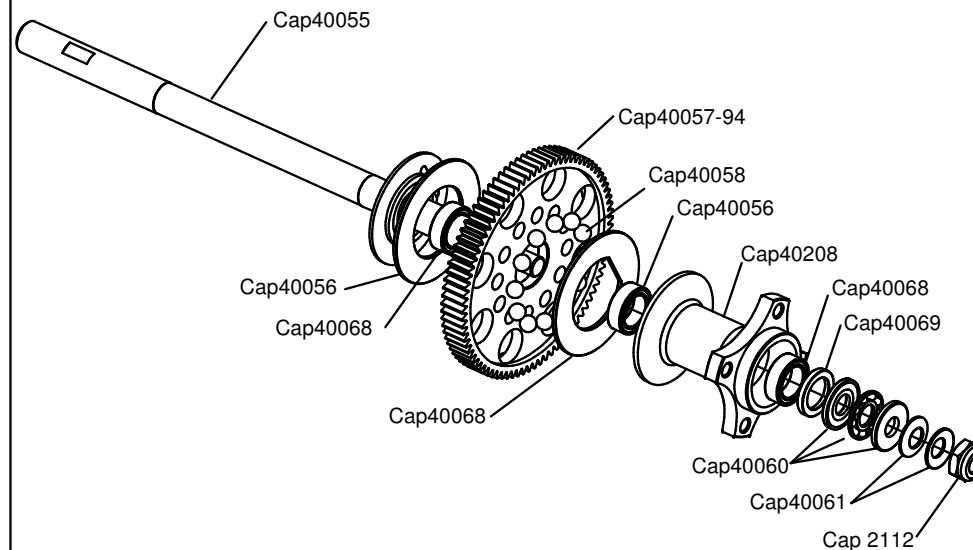
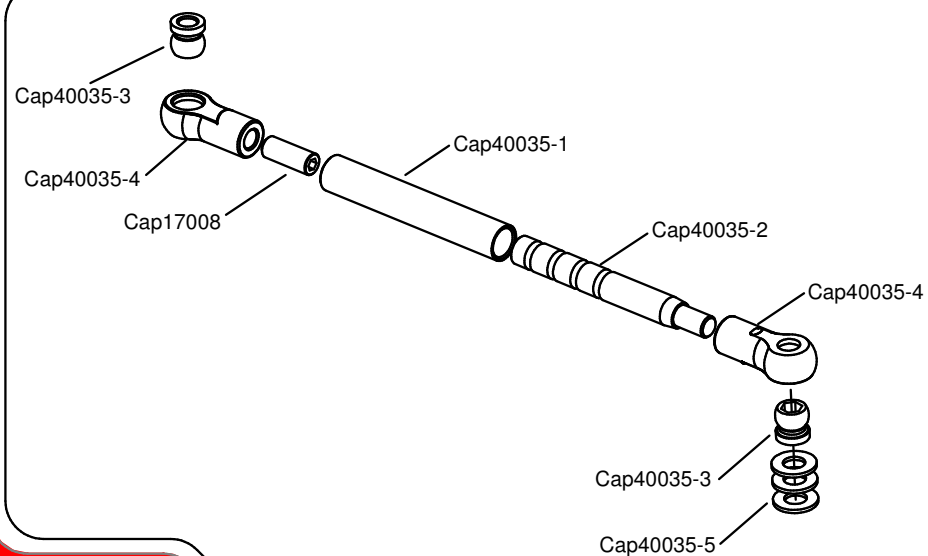
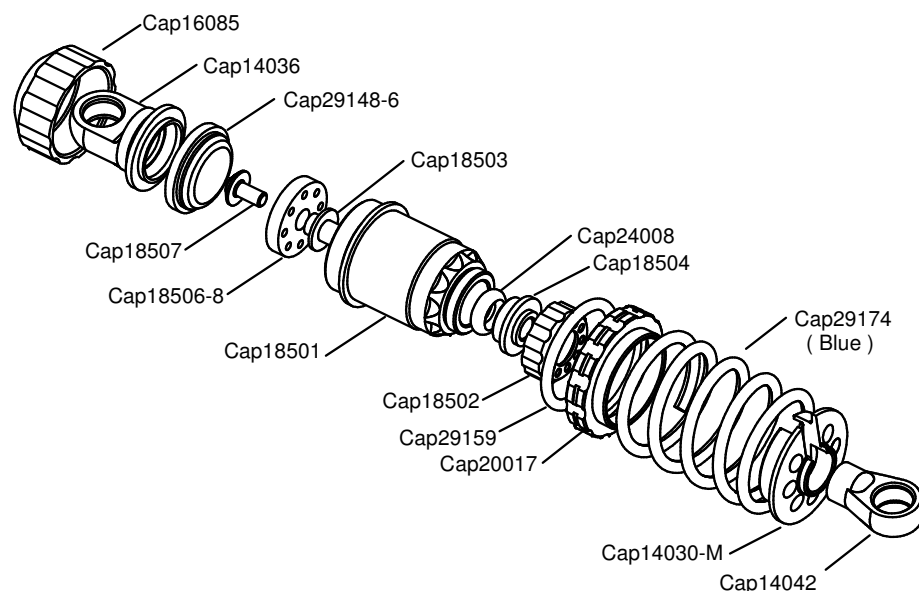

Made in Italy



- Front exploded -

Capricorn RC

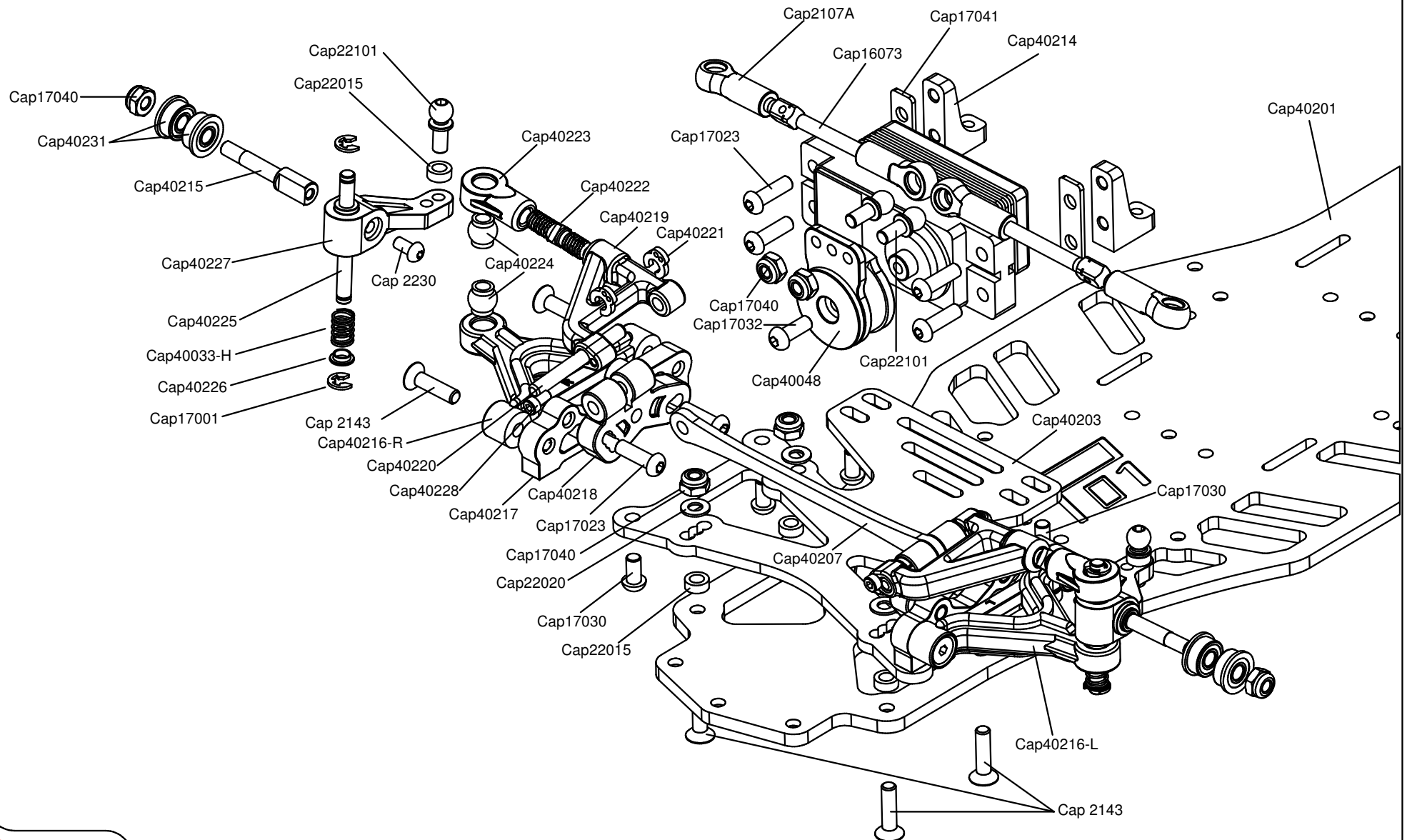

Made in Italy



- Center & bodymount -
exploded

Capricorn RC

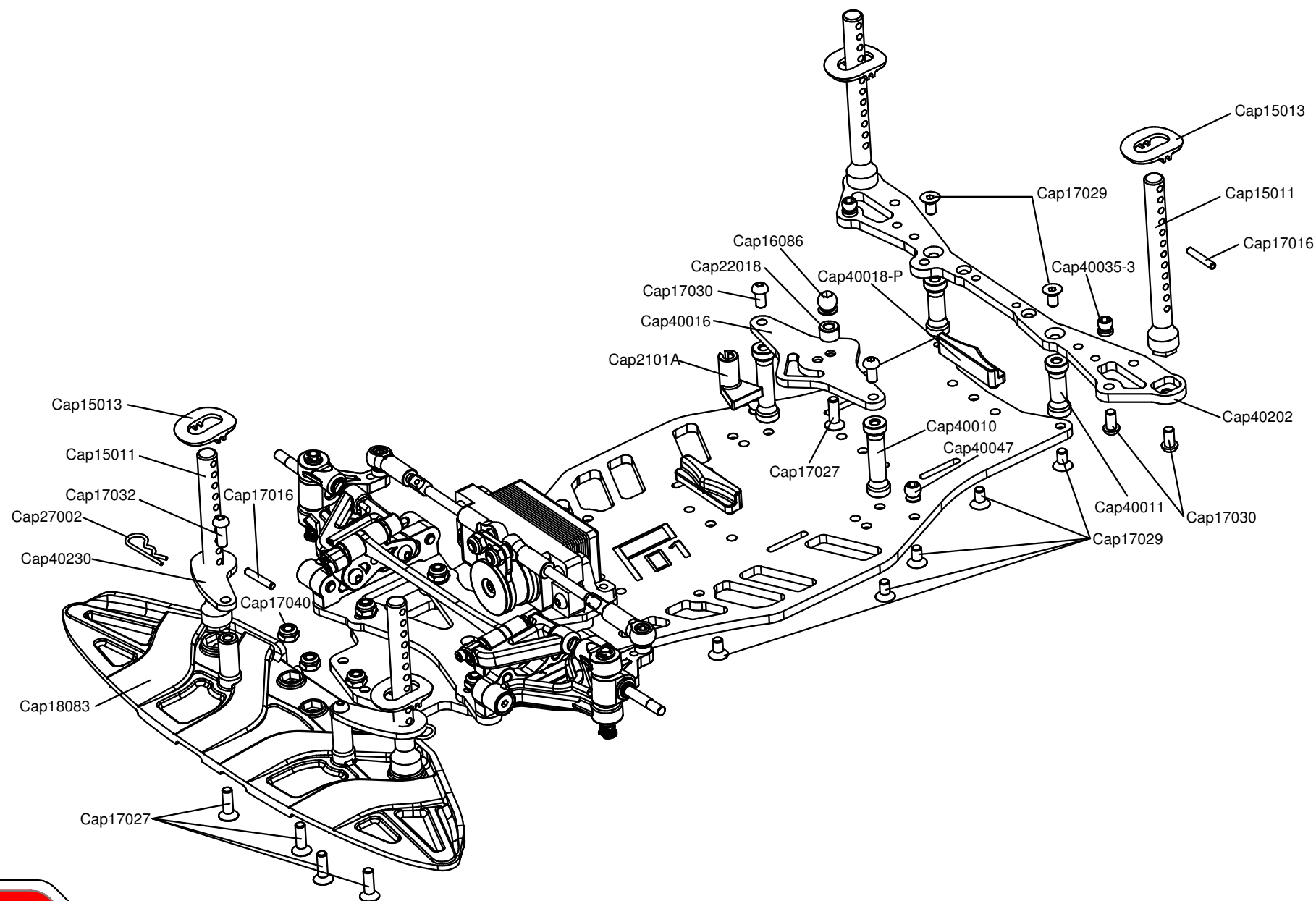

Made in Italy



- Rear exploded -

Capricorn RC

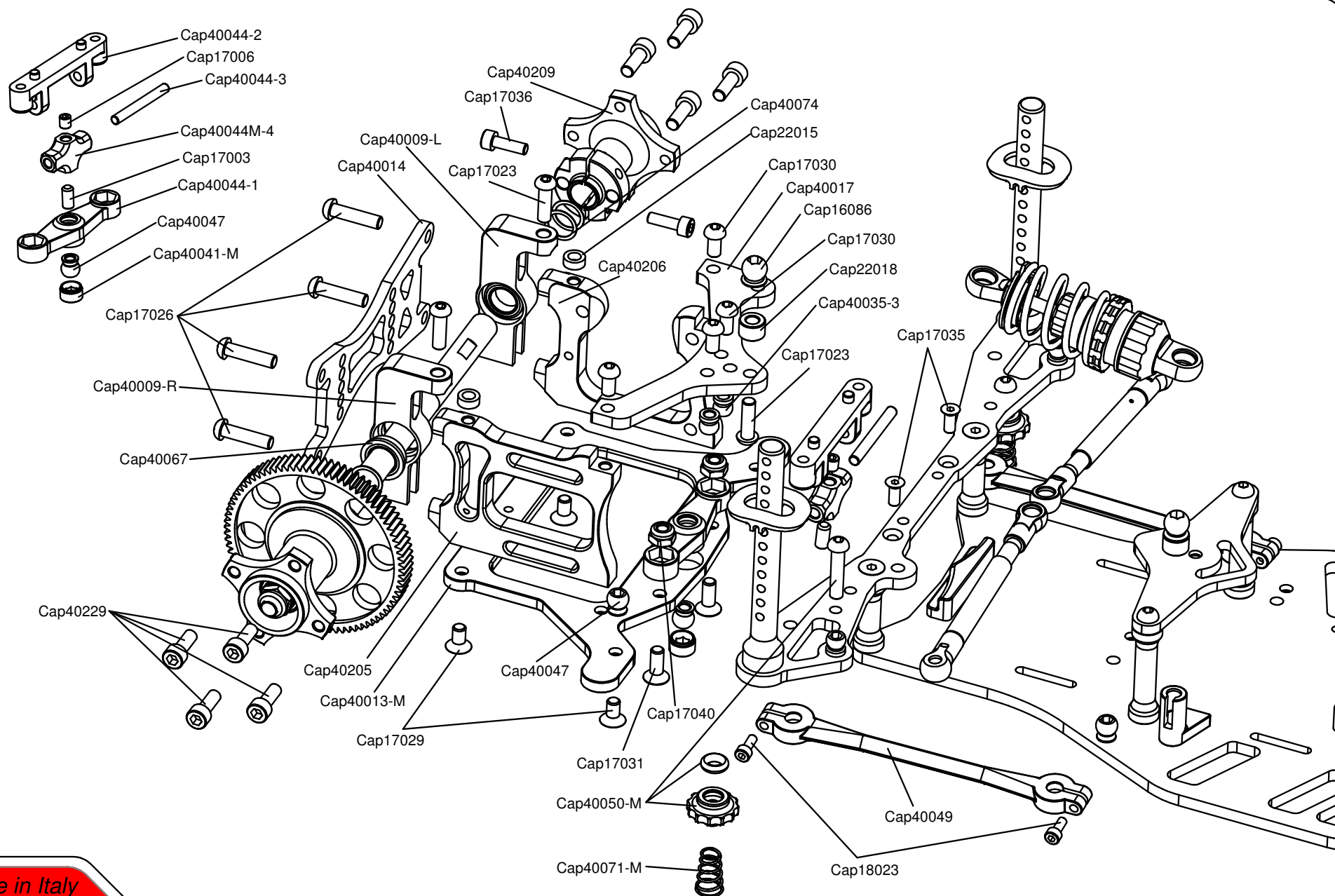

Made in Italy



- 235 mm Conversion -
Shorty Li-Po Battery

Capricorn RC

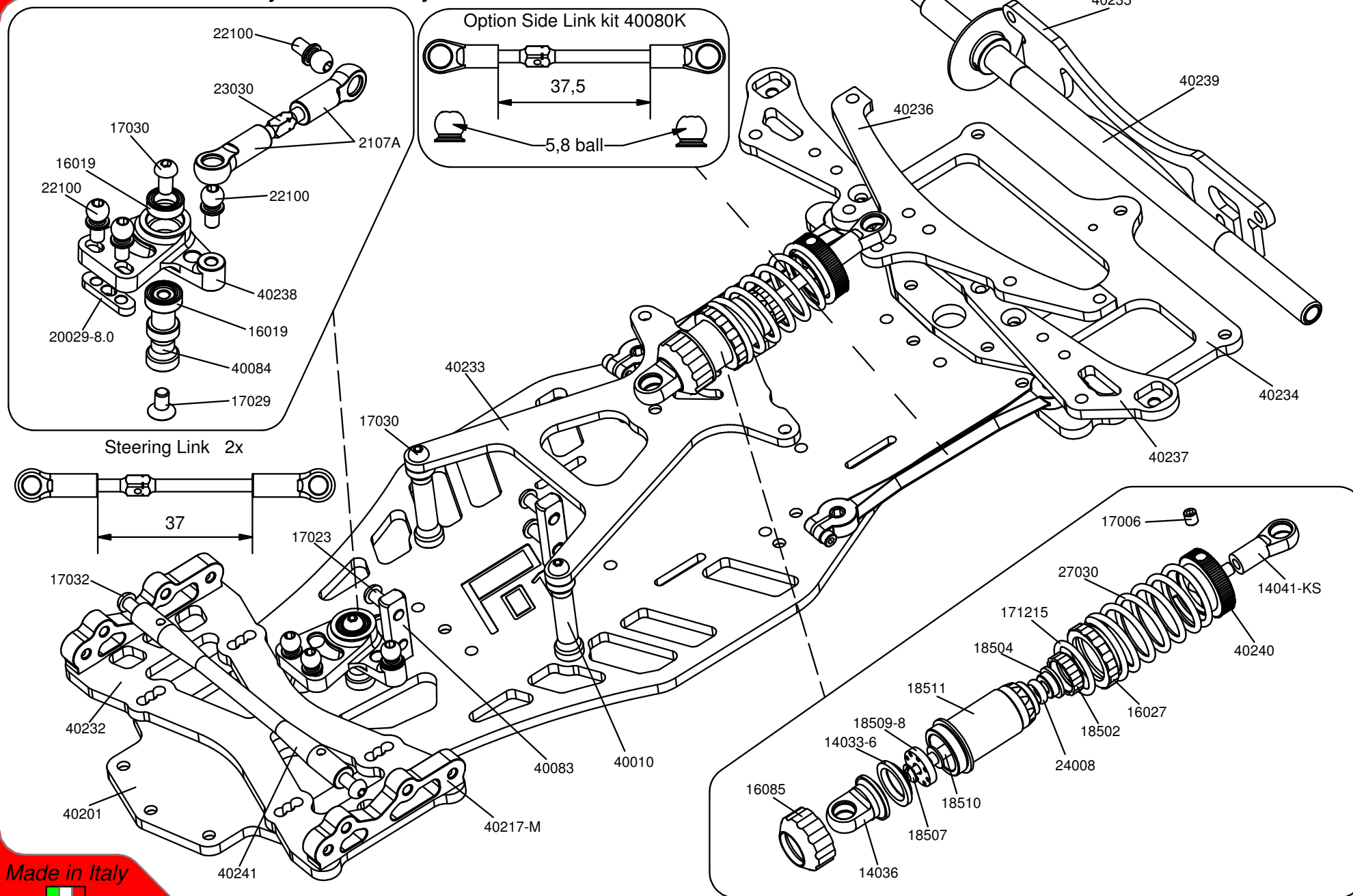

Made in Italy



- 235 mm Conversion -
Std Li-Po battery

Capricorn RC

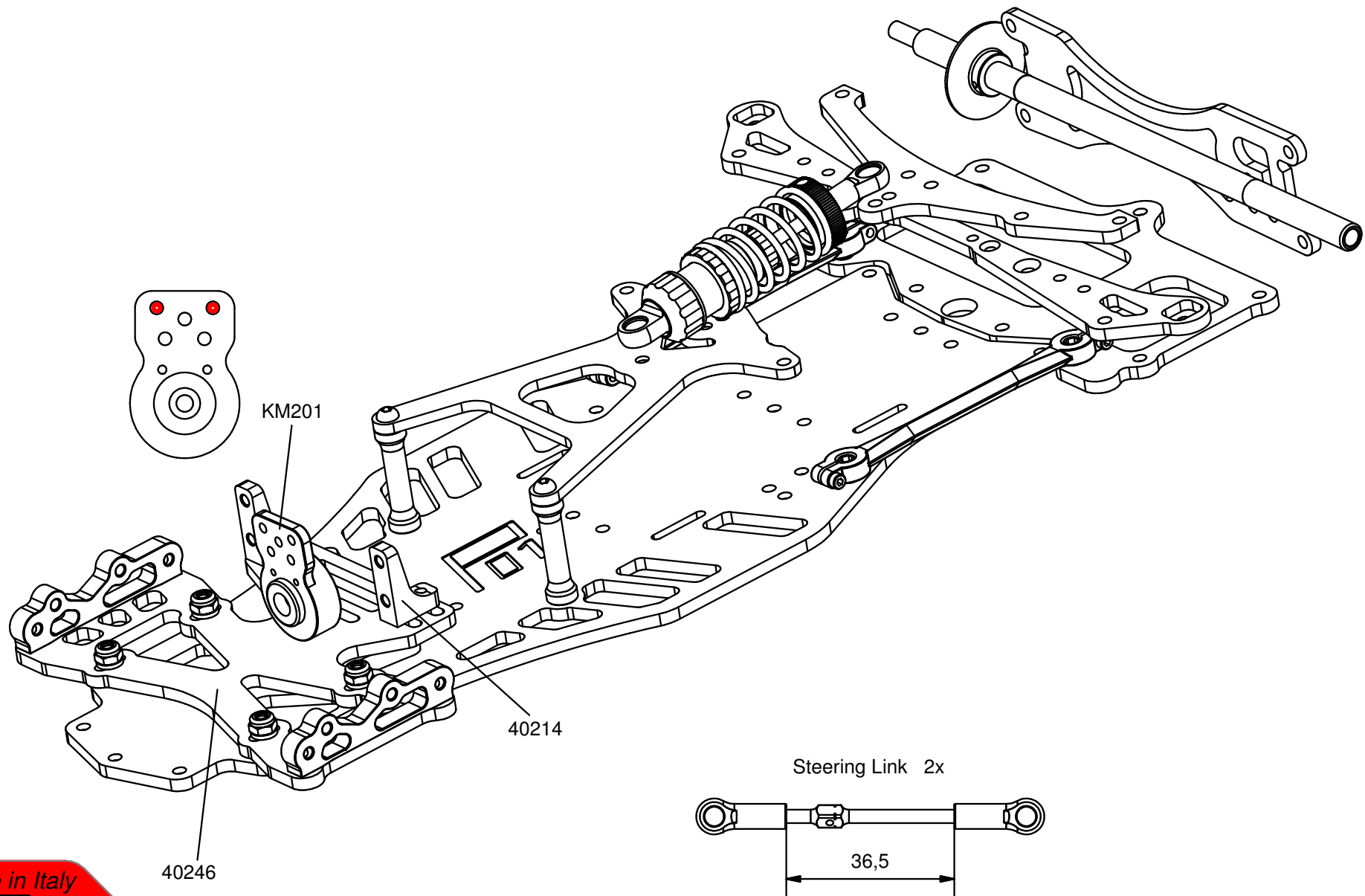

Made in Italy

- 235 mm Conversion - *Capricorn RC*

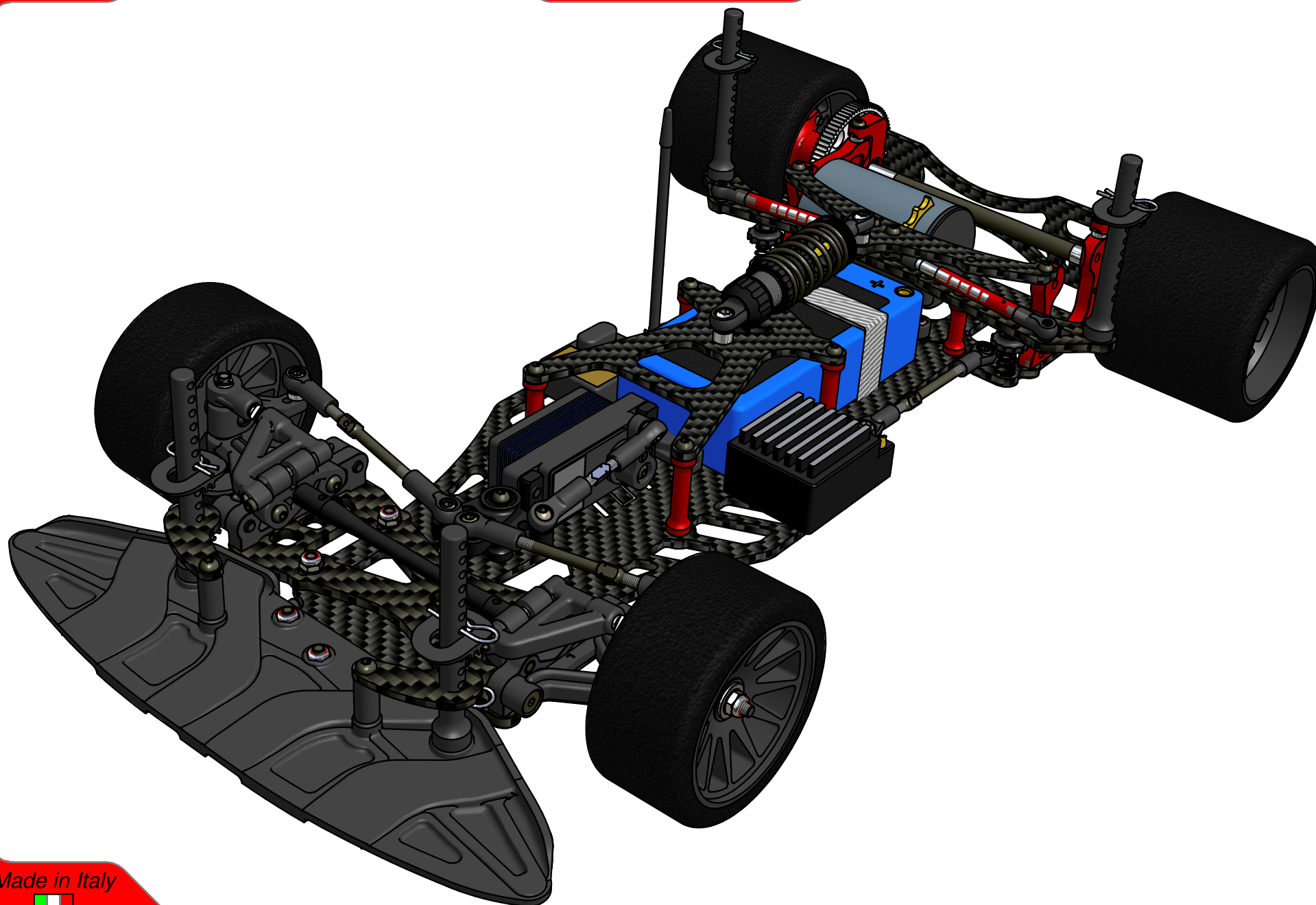

Made in Italy

- Additional Notes -

Capricorn RC

[illegible]

Made in Italy

